

Product Improvement Announcement

New DR400 Metal Handle

Issue date: 23 March 2022

Product Change Description

Effective March 23rd, 2022, a new metal handle will be available for the DR400. The metal handle 5K6P0DXX will replace 5T7P0DXX.



Product Improvements

- The new DR400 Metal handle has an integrated cable gland and increased handle ID for ease of wiring.
- "H" style wings on the handle have been added for increased impact protection on receptacles and inlets.
- Side handles have been added making it easier for the transporting and installing the handle.
- Handle body design provides provisions should users choose to install their own cord grip for mounting pilot wires.

Sealing and Cable Anchorage

Sealing is accomplished when an elastomer ring is compressed and secured under the cable gland body into the handle body with 4 stainless steel screws (BTR M6 x 40). After sealing the cable gland body to the handle body, the clamps are tightened with 2 stainless steel screws (BTR M8). The tightening should be alternated to ensure the clamps go on evenly.

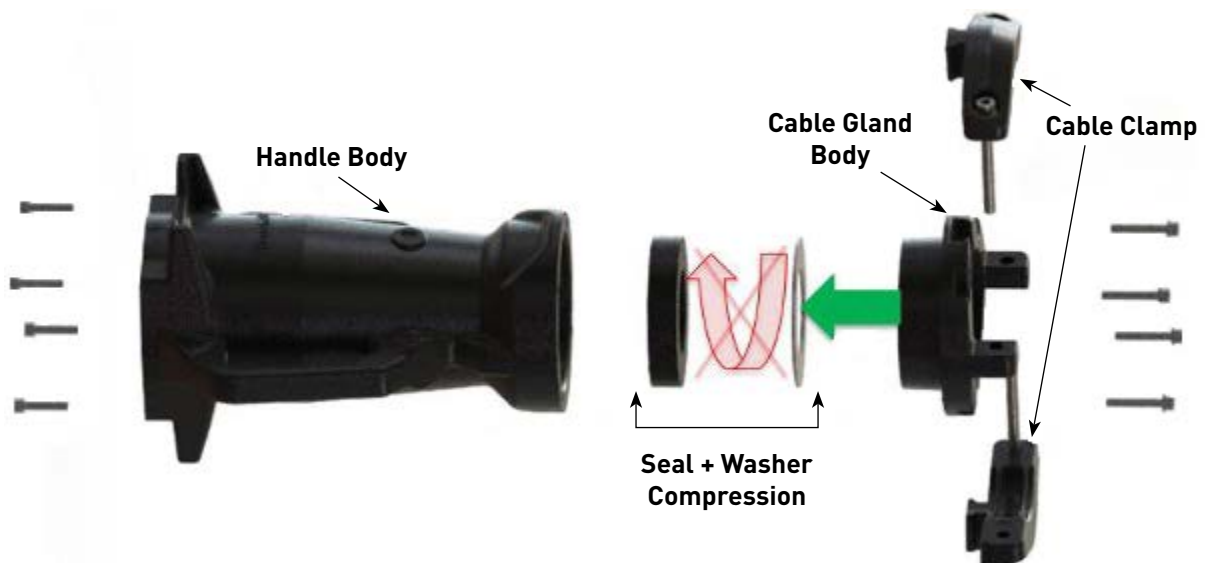

meltric.com

4765 W. Oakwood Park Drive • Franklin, WI 53132
414-433-2700 • Fax 414-433-2701

©2022 MELTRIC Corporation. All rights reserved. PIADR400HANDLE_A

MELTRIC
A COMPANY OF MARECHAL ELECTRIC

Catalog Part Numbers

Part #	5K6P0D50	5K6P0D60	5K6P0D70	5K6P0D80
Cable Range Ø in	1.57"-1.97"	2.01"-2.36"	2.40"-2.76"	2.79"-3.15"
Cable Range Ø mm	40mm-50mm	51mm-60mm	61mm-70mm	71mm-80mm

Cable Range Diameter Cross Reference

Old Handle Part #	ST7P0D57	ST7P0D62		ST7P0D68	ST7P0D73	
Cable Range Ø in	2.09"-2.25"	2.25"-2.36"	2.40"-2.44"	2.44"-2.67"	2.67"-2.76"	2.79"-2.87"
Cable Range Ø mm	53mm-57.15mm	57.15mm-59.94mm	61mm-61.97mm	61mm-61.97mm	67.81mm-70.1mm	71mm-72.89mm
New Handle Part #	5K6P0D60	5K6P0D60	5K6P0D70	5K6P0D70	5K6P0D70	5K6P0D80
Cable Range Ø in	2.01"-2.36"	2.01"-2.36"	2.40"-2.76"	2.40"-2.76"	2.40"-2.76"	2.79"-3.15"
Cable Range Ø mm	51mm-60mm	51mm-60mm	61mm-70mm	61mm-70mm	61mm-70mm	71mm-80mm

Dimensions

This drawing is the property of MELTRIC Corporation, Franklin, Wisconsin, USA. Any unauthorized copying of this drawing or any portion thereof is prohibited. All dimensions are in inches unless otherwise specified. ©2022 MELTRIC Corporation. All rights reserved. PIADR400HANDLE_A 10/21/21

Dimensions shown in drawing:

- Top view: 7.40 (height), 8.55 (width)
- Front view: (13.3) (height)
- Bottom view: 3.86 (width)

PART NUMBER	CABLE RANGE
5K6P0D50	1.575" TO 1.969" (40 TO 50mm)
5K6P0D60	2.008" TO 2.362" (51 TO 60mm)
5K6P0D70	2.402" TO 2.756" (61 TO 70mm)
5K6P0D80	2.795" TO 3.150" (71 TO 80mm)

TOLERANCES UNLESS OTHERWISE SPECIFIED

MACHINED SURFACES ± 0.005 MAX
 GROUND SURFACES ± 0.005 MAX
 ANGLE TOLERANCE $\pm 1^\circ$
 REMOVE BURRS & SHARP EDGES TO 0.015 MAX.
 DIMENSIONS SHOWN IN OVALS ARE INSPECTION DIMENSIONS

ENGLISH
 0.X ± 0.05
 0.XX ± 0.01
 0.XXX ± 0.005

MELTRIC
 A COMPANY OF MARECHAL ELECTRIC

DRWNR: [] APPROVED: [] DRAWING TITLE: SIZE 6 & 7 HANDLE W/INTEGRATED CORD GRIP
 DATE: [] SCALE: NTS MATERIAL: ALUMINUM, PAINTED BLACK
 SHEET: 1 OF 1 PART NUMBER: 5K6P0Dxx REVISION: []