

MULTIPIN Spare Parts

Male Configuration

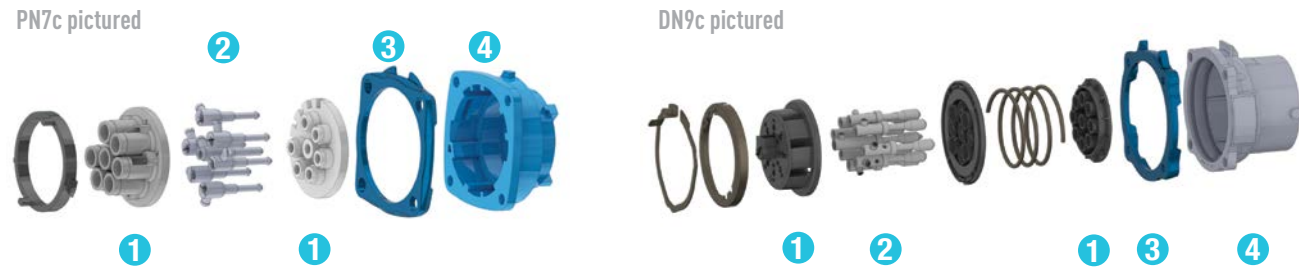

	DSN12c POLY	DSN24c POLY	DSN37c POLY	DS24c SS	DS37c SS
Plug Insulator	63-AA910	63-BA910	63-CA910	37-BA910-SS	37-CA910-SS
Plug Contact (Qty = 13)	63-AA113	63-BA113	63-CA113	37-BA113	37-CA113
Plug Casing	63-1A105	63-3A105	63-6A105	37-1A014-SS	37-CA014-SS
Device Gasket	63-1AB26	63-3AB26	63-6AB26	37-1A026-SS	37-3AB26

	PN7c POLY	PN7c METAL	PN12c POLY	PN12c METAL
1 Plug Insulator	03-PA910	07-PA910	03-AA910	07-AA910
2 Plug Contact	03-PA911	07-PA911	-	-
2 Plug Contact (Qty = 13)	-	-	03-AA113	07-AA113
2 Plug Ground Contact	03-PA919	07-PA919	-	-
3 Device Gasket	03-NAB26	07-NAB26	03-NAB26	07-NAB26
4 Plug Casing	03-NA014	07-NA014	03-NA014	07-NA014

	DN9c METAL	DN20c METAL	DS7c/ DR7c POLY	DS7c/ DR7c METAL
1 Plug Insulator	17-1A910	17-6A910	33-3A910-263	39-3A910-263
2 Plug PhaseContact (Short Outside)	17-1A911	17-6A911	33-3A911	39-3A911
2 Plug Phase (Pilot) Contact (Long Inside)	17-1A711	17-6A711	33-3A911-172	39-3A911-172
2 Plug Ground Contact	17-1A919	17-6A919	33-3A919	39-3A919
3 Device Gasket	17-1AB26	17-6AB26	33-6AB26	39-6AB26
4 Plug Casing	17-1A014	17-6A014	33-6A014	39-6A014

Please provide full part number for accurate part alignment.

Part numbers in catalog are for current revisions, others may be available upon request.

For replacement parts contact Customer Service at 800-433-7642.

Female Configuration



	DSN12c POLY	DSN24c POLY	DSN37c POLY	DS24c SS	DS37c SS
Receptacle Insulator	63-AA920	63-BA920	63-CA920	37-BA920-SS	37-CA920-SS
Receptacle Contact (Qty = 13)	63-AA213	63-BA213	63-CA213	37-BA213	37-CA213
Receptacle Casing	63-1A305	63-3A305	63-6A305	37-1A024-SS	37-CA024-SS
Lid Replacement Kit	63-1A125	63-3A125	63-6A125	-	-
Pawl Replacement Kit	63-1A824	63-3A824	63-6A824	-	-
Device Gasket	63-1AB26	63-3AB26	63-6AB26	37-1A026-SS	37-3AB26

	PN7c POLY	PN7c METAL	PN12c POLY	PN12c METAL
1 Receptacle Insulator	03-PA920	07-PA920	03-AA920	07-AA920
2 Receptacle Contact	03-PA921	07-PA921	-	-
2 Receptacle Contact (Qty=13)	-	-	03-AA213	07-AA213
2 Receptacle Ground Contact	03-PA929	07-PA929	-	-
3 Device Gasket	03-NAB26	07-NAB26	03-NAB26	07-NAB26
4 Receptacle Casing	03-NA024	07-NA024	03-NA024	07-NA024

	DN9c POLY	DN20c METAL	DS7C/DR7C POLY	DS7C/DR7C METAL
1 Receptacle Insulator	17-1A920	17-6A920	33-3A920-263	39-3A920-263
2 Receptacle Phase Contact (Short Outside)	17-1A921	17-6A921	33-3A921	39-3A921
2 Receptacle Phase (Pilot) Contact (Long Inside)	17-1A721	17-6A721	33-3A921-172	39-3A921-172
2 Receptacle Ground Contact	17-1A929	17-6A929	33-3A929	39-3A929
3 Device Gasket	17-1AB26	17-6AB26	33-6AB26	39-6AB26
4 Receptacle Casing	17-1A024	17-6A024	33-6A024	39-6A024
4 Replacement Lid	17-1A925	17-6A925	33-6A125	39-6A925