



Update Your Plugs & Receptacles to Ensure Arc Flash Protection & NFPA 70E Compliance

NFPA 70E recommended safety procedures not only apply to MCC's and large switchgear, but they also cover the plugs & receptacles used to connect welders, pumps, and other portable equipment. Because many of the standard plugs and receptacles currently in service have accessible live parts and can be hazardous if connected or disconnected under load, users must either update their equipment or follow cumbersome safety procedures in order to comply with NFPA 70E.

MELTRIC Makes it Easy

Replace existing plugs & receptacles with MELTRIC's Switch-Rated Plugs & Receptacles using DECONTACTOR™ technology to simplify NFPA 70E compliance.

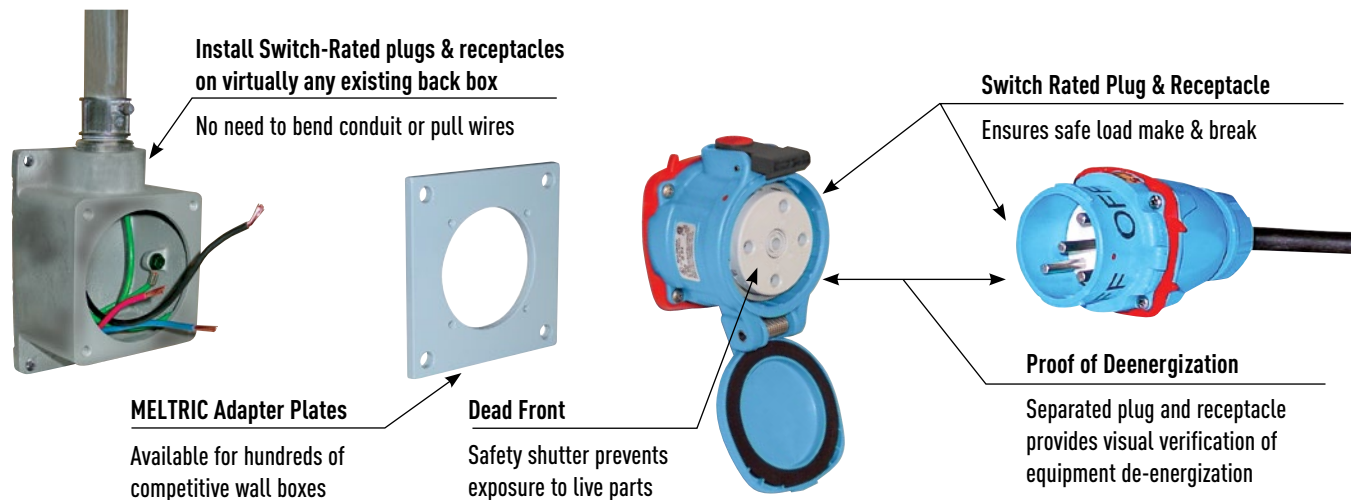

Avoid dangers and hassles of traditional plugs



Warning Arc Flash Hazard

Most pin & sleeve and twist type devices are not intended to be connected or disconnected under load. Doing so may expose users to live contacts and arc flash hazards that can result in serious injuries.



Requirement Costly Procedures

NFPA 70E requires verification that the power is OFF before most standard plugs & receptacles can be connected or disconnected. In many cases, this requires voltage testing by a 'qualified' worker wearing PPE.



Caution Dangerous Work Practices

The expensive interlocks required to prevent standard plugs & receptacles from being connected or disconnected under load are completely defeated when workers use extension cords.



Switch-Rated Advantages

✓ **Switch ratings ensure safe load breaking/making – even in overload situations.**

MELTRIC's Switch-Rated plugs & receptacles are switch rated up to 200A & 75 hp. They provide short circuit make & withstand protection up to 100kA.

✓ **Dead front construction prevents exposure to live parts and arc flash hazards.**

Making and breaking electrical connections with MELTRIC's Switch-Rated plugs & receptacles meet NFPA 70E's 'Normal Operation' definition, so no special personal protective equipment is required. There is no need to 'suit-up' with cumbersome PPE.

✓ **Separation of the plug & receptacle provides verification of deenergization.**

Voltage testing is not required. Visible contact separation proves the power is off.

✓ **Plug & play simplicity allows any qualified employee to quickly connect and disconnect electrical equipment.**

Specially trained electrical workers are not required for load making/breaking. Downtime related to equipment change-outs can be reduced by up to 50%.

✓ **Lockout provisions facilitate easy compliance with lockout/tagout requirements.**

Only your lock and tag are needed, no additional mechanisms are required. (Provisions are standard on the plug and optional on the receptacle.)

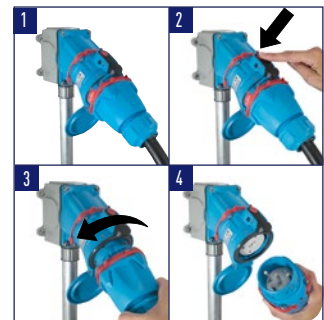

NEC, UL & CSA Compliance

In addition to their plug & receptacle listings, Meltric Switch-Rated Plugs & Receptacles are UL and CSA switch-rated and are approved NEC 'line of sight' disconnect switches for both resistive and inductive loads.

- UL listed for 'Branch Circuit Disconnect Switching' and 'Motor Circuit Disconnect Switching' per UL Subject 2682 'Switch-Rated Plugs & Receptacles'.
- CSA listed as 'Branch Circuit Disconnect Switches' and as 'Manual Motor Controllers' per CSA C22.2 no. 4 and no. 14.

Presented by MELTRIC and:

