

## Optional Metal Pawls on Poly Receptacles

### product description – metal pawls



**Optional Metal Pawls now available**

Metal pawls can now be ordered as an option on DSN, DS, DR, DSDC and DXN Series poly receptacles.

#### Benefits of Metal Pawls

Metal pawls offer increased impact resistance and tensile strength for rough applications that frequently occur at shipyards, steel mills, large metal fabrication shops and other similar environments.

Customers who anticipate rough handling of their receptacles should consider specifying metal pawls instead of the standard poly pawls on all future orders.

### ordering instructions and pricing

Model	Receptacle Option	Suffix #
<b>DSN20</b>	Metal Pawl	-824
<b>DSN30</b>	Metal Pawl	-824
<b>DSN60</b>	Metal Pawl	-824
<b>DSN24c</b>	Metal Pawl	-824
<b>DSN37c</b>	Metal Pawl	-824
<b>DS20/DR30/DSDC1</b>	Metal Pawl	-824
<b>DS30/DR50/DSDC3</b>	Metal Pawl	-824
<b>DS60/DS100C/DR100/DSDC6</b>	Metal Pawl	-824
<b>DS100/DR150/DSDC9</b>	Metal Pawl	-824
<b>DXN20</b>	Metal Pawl	-924
<b>DXN30</b>	Metal Pawl	-924
<b>DXN60</b>	Metal Pawl	-924

\*DSN30 receptacles with metal pawls are not available at the time of this announcement. Availability is expected in the 3rd quarter.

# Optional Metal Pawls on Poly Receptacles

## product description – pawl replacement kits

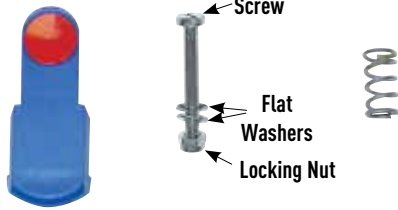

For replacement of pawls on existing plugs and receptacles Meltric offers Pawl Replacement Kits. Replacement kits consisting of either poly or metal pawls are available. Each kit includes a pawl, required hardware, and instructions.

## ordering instructions and pricing

Model	Material	Part Number
DSN20	Poly	61-1A824
DSN20	Metal	69-1A824
DSN30-old style*	Poly	61-3A824
DSN30-old style*	Metal	69-3A824
DSN30-new style*	Poly	61-6A824
DSN30-new style*	Metal	69-6A924
DSN60-old style – before 9/2010	Poly	69-6A824-AD303
DSN60-old style – before 9/2010	Metal	69-6A824
DSN60-new style – after 9/2010	Poly	61-6A824
DSN60-new style – after 9/2010	Metal	69-6A924
DS20/DR30/DSDC1	Poly	31-1A824
DS20/DR30	Metal	39-1A824
DS30/DR50/DSDC3	Poly	31-3A824
DS30/DR50	Metal	39-3A824
DS60/DS100C/DR100/DSDC6	Poly	31-6A824
DS60/DS100C/DR100/DSDC6	Metal	39-6A824
DS100/DR150/DSDC9	Poly	61-9A824
DS100/DR150/DSDC9	Metal	39-9A824
DS200/DR250/DSDC2	Metal	39-2A824

\* Old style DSN30 casings are the current casings at the time of this announcement. New style DSN30 casings will be implemented in 3rd quarter 2013.

## faq

### Are the metal pawl options listed in the catalog?

Metal pawl option suffixes are listed in the 2013 Meltric catalog for DSN, DS, DR, DXN and DSDC product lines.

### Is pricing available in the price book?

Pricing for the metal pawl options and the replacement kits is NOT in the 2013 price list. Contact customer service for pricing.