

# PN7c/DN9c SPARE PARTS Male Configuration

PN7c pictured

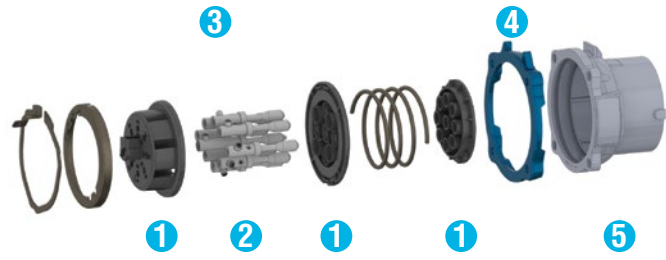

DN9c pictured



	DSN24c POLY	DSN37c POLY	DS7c/ DR7c POLY	DS7c/ DR7c METAL
Plug Interior	61-BA910	61-CA910	31-6A014	39-6A014
Plug Contact (Qty = 13)*	61-BA113	61-CA113	31-3A911	31-3A911
Plug Ground Contact (Qty = 13)*	61-BA113	61-CA113	31-3A911-172	31-3A911-172
Plug Casing**	61-3A105	61-6A105	31-3A910-263	31-3A910-263
Device Gasket	61-3AM26	31-3AM26	31-6AM26	31-6AM26
Stainless Steel Casing	39-1A014-SS	39-3A014-SS	31-3A919	31-3A919
Interior for Stainless Plug	61-BA910-SS	-		

\* If a DSN24c or 37c device was originally purchased before February 2013, contact customer service for parts.

\*\* If a DSN24c or 37c device was originally purchased before March 2015, contact customer service for casing parts.

	PN7c POLY	PN7c METAL	PN12c POLY	PN12c METAL
1 Plug Interior, Ground Contact & Connection	01-PA910	09-PA910	01-AA910	09-AA910
2 Plug Contact (PN12c Qty = 13)*	09-PA911	09-PA911	01-AA113	01-AA113
3 Device Gasket	61-1AM26	61-1AM26	61-1AM26	61-1AM26
4 Plug Casing	01-NA014	09-NA014	01-NA014	09-NA014
5 Ground Contact (PN12c Qty = 13)*	09-PA919	09-PA919	01-AA113	01-AA113

\* If the PN12c device was purchased before March 2013, contact customer service for parts.

	DN9c METAL	DN20c METAL
1 Plug Interior	19-1A910	19-6A910
2 Plug Contact (Short/Outside)	19-1A911	19-6A911
2 Device Gasket (Long/Inside)	19-1A711	19-6A711
3 Plug Ground Contact	19-1A919	19-6A919
4 Plug Casing	19-1A014	19-6A014
5 Device Gasket	31-3A026	31-9A026

# PN7c/DN9c SPARE PARTS Female Configuration

PN7c pictured

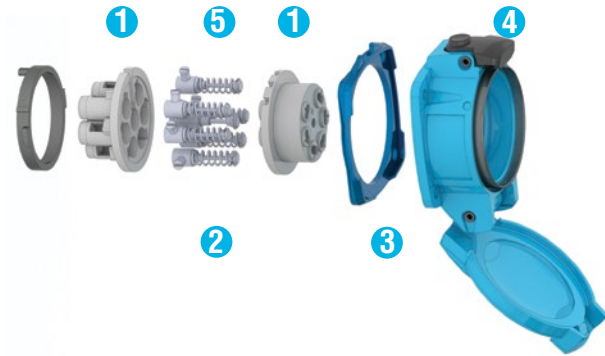

DN9c pictured



	DSN24c POLY	DSN37c POLY	DS7c/ DR7c POLY	DS7c/ DR7c METAL
Receptacle Interior	61-BA920	61-CA920	Receptacle Casing	31-6A024
Receptacle Contact (Qty = 13)*	61-BA213	61-CA213	Receptacle Phase Contact	31-3A921
Receptacle Ground Contact (Qty = 13)*	61-BA213	61-CA213	Receptacle Pilot Contact	31-3A921-172
Receptacle Casing**	61-3A305	61-6A305	Receptacle Interior	31-3A920-263
Device Gasket	61-3AM26	31-3AM26	Device Gasket	31-6AM26
Stainless Steel Casing	39-1A024-SS	39-3A024-SS	Ground Contact	31-3A929
Interior for Stainless Receptacle	61-BA920-SS	-		

\* If the DSN24c or 37c device was originally purchased before February 2013, contact customer service for parts.

\*\* If the DSN24c or 37c device was originally purchased before March 2015, contact customer service for casing parts.

	PN7c POLY	PN7c METAL	PN12c POLY	PN12c METAL
1 Receptacle Interior & Retaining Ring	01-PA920	09-PA920	01-AA920	09-AA920
2 Receptacle Contact (PN12c Qty = 13)*	09-PA921	09-PA921	31-CA213	31-CA213
3 Device Gasket	61-1AM26	61-1AM26	61-1AM26	61-1AM26
4 Receptacle Casing	01-NA024	09-NA024	01-NA024	09-NA024
5 Ground Contact (PN12c Qty = 13)*	09-PA929	09-PA929	31-CA213	31-CA213

\* If the PN12c device was purchased before March 2013, contact customer service for parts.

	DN9c METAL	DN20c METAL
1 Receptacle Interior	19-1A920	19-6A920
2 Receptacle Contact (Short/Outside)	19-1A921	19-6A921
2 Receptacle Contact (Long/Inside)	19-1A721	19-6A721
3 Receptacle Ground Contact	19-1A929	19-6A929
4 Receptacle Casing	19-1A024	19-6A024
5 Lid, Gasket, Roll Pin & Spring	19-1A925	19-6A925
6 Device Gasket	31-3A026	31-9A026